

ASSEMBLY INSTRUCTIONS MANUAL DE MONTAGEM / INSTRUCCIONES DE ARMADO

LIMEIRA HIGH MULTIUSE CABINET
ARMARIO MULTIUSO LIMEIRA ALTO
ARMARIO MULTIUSO LIMEIRA ALTO

Reference 3265 | Revise 00
Referência 3265 | Revisão 00
Referencia 3265 | Revisión 00

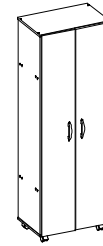

YOU WILL NEED
VOCÊ VAI PRECISAR DE / USTED NECESITARÁ

Tools not supplied
Ferramentas não fornecidas / Herramientas no incluidas

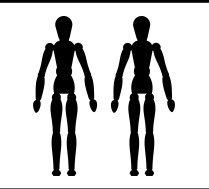

2 People
2 Pessoas
2 Personas

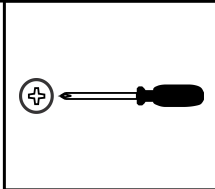

Screwdriver Phillips
Chave Phillips
Destornillador cruz

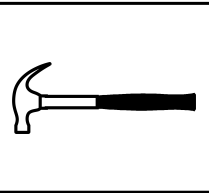

Hammer
Martelo
Martillo



MAXIMUM RECOMMENDED WEIGHT
BEING THIS EVENLY DISTRIBUTED.

PESO MÁXIMO RECOMENDADO SENDO
ESTE DISTRIBUÍDO UNIFORMEMENTE.

PESO MÁXIMO RECOMENDADO SIENDO
ESTE UNIFORMEMENTE DISTRIBUIDO.

	LB	KG
D	11	5

PARTS IDENTIFICATION
IDENTIFICAÇÃO DAS PEÇAS / IDENTIFICACIÓN DE LAS PIEZAS

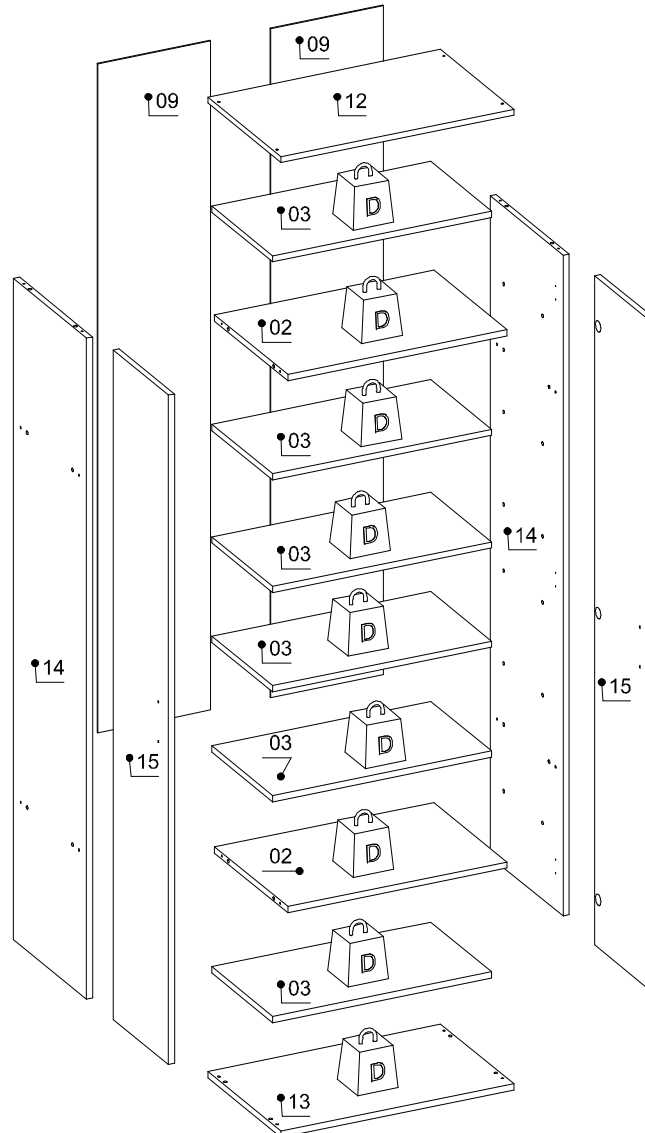

Nº	Measures_Inches	Medidas_cm	Qty./Qtd.
02	21 1/4 x 14 1/8 x 5/8	54.0 x 36.0 x 1.5	2
03	21 1/4 x 11 3/4 x 5/8	54.0 x 30.0 x 1.5	6
09	63 3/4 x 11 x 1/8	161.8 x 27.8 x 0.3	2
12	22 5/8 x 14 1/8 x 5/8	57.4 x 36.0 x 1.5	1
13	22 5/8 x 14 1/8 x 5/8	57.4 x 36.0 x 1.5	1
14	62 7/8 x 14 1/8 x 5/8	159.8 x 36.0 x 1.5	2
15	63 3/4 x 10 3/4 x 5/8	161.8 x 27.3 x 1.5	2

IDENTIFICATION OF ACCESSORIES IDENTIFICAÇÃO DOS ACESSÓRIOS/ IDENTIFICACIÓN DE ACCESORIOS



The separation of the accessories before you start the assembly will facilitate the same. In case of doubt on the size of the screws and bolts, use the ruler at the bottom of the page.
 A separação dos acessórios antes de iniciar a montagem facilitará a mesma. Em caso de dúvida no tamanho dos parafusos e cavilhas, utilize a régua ao final da página.
 La separación de los accesorios antes de comenzar el armado facilitará el mismo. En caso de duda sobre el tamaño de los tornillos y taquetes, utilice la regla al pie de página.

A6		"H" profile Perfil "H" / Perfil "H"	-	1
C2		Handle Puxador Partenon / Tirador	96 mm	2
D5		Hinge shim Calço dobradiça / Bisagra de calce	-	6
F6		Metal hinge curve Dobradiça curva / Esquina de bisagra metálica	26 mm	6
E		Wooden dowel Cavilha / Taquete	8x30 mm	16
E3		Shelf bracket Suporte de prateleira / Suporte de repisa	8x7 mm	24
G		Structural screw Parafuso estrutural / Tornillo estructural	5,0x50	16
H		Allen key Chave allen / Liave allen	3 mm	1
H6		Caster Rodízio 40 / Rueda	-	4
I		Structural screw cover Tapa parafuso estrutural / Tapa tornillo estructural	-	12
N		Nail Prego / Clavo	10x10	46
S		Pan head screw Parafuso panela / Tornillo de pan	3,5x14 mm	40
T		Flanged head screw Parafuso flangeado / Tornillo de cabeza flangeada	3,5x25 mm	4
Z		Plastic hole plugs Tapa furo plástico / Tapones plásticos	8 mm	8

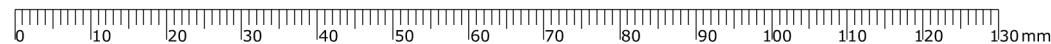

PRE-ASSEMBLE PRÉ-MONTAGEM / PRE ARMADO

01

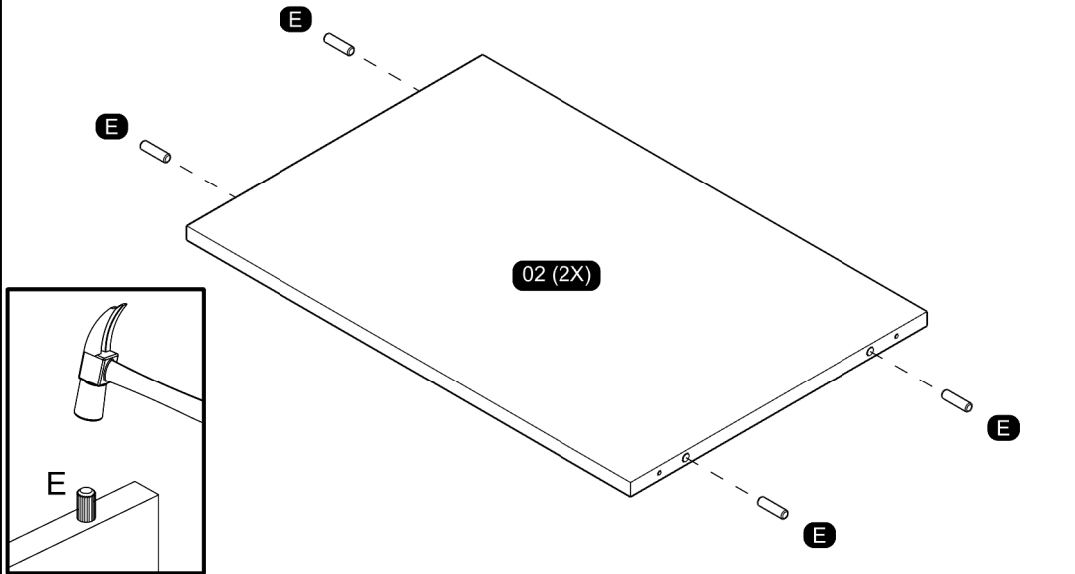

02

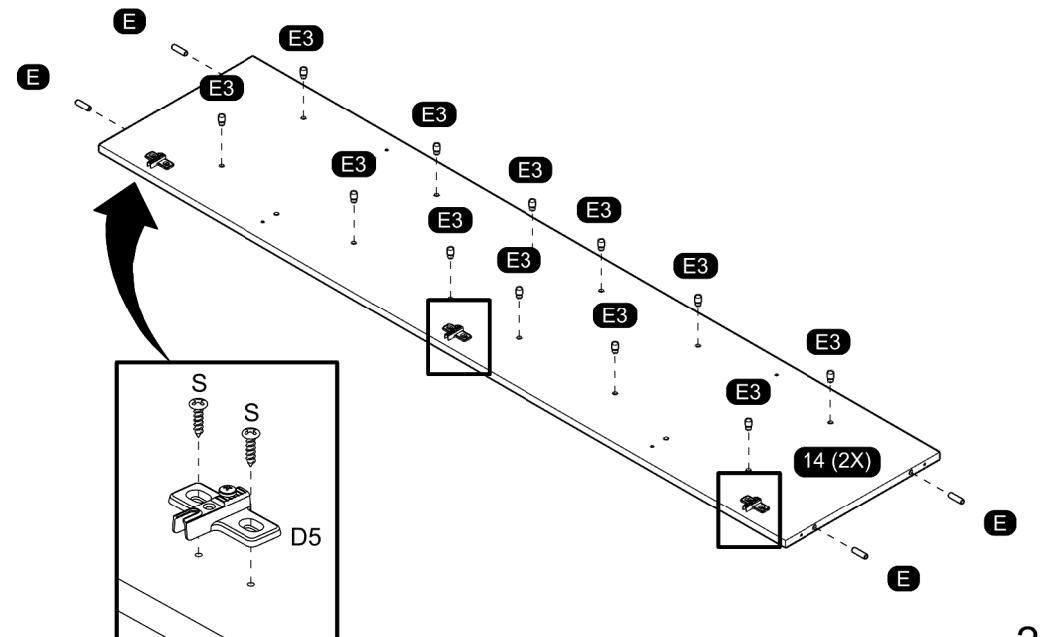

03

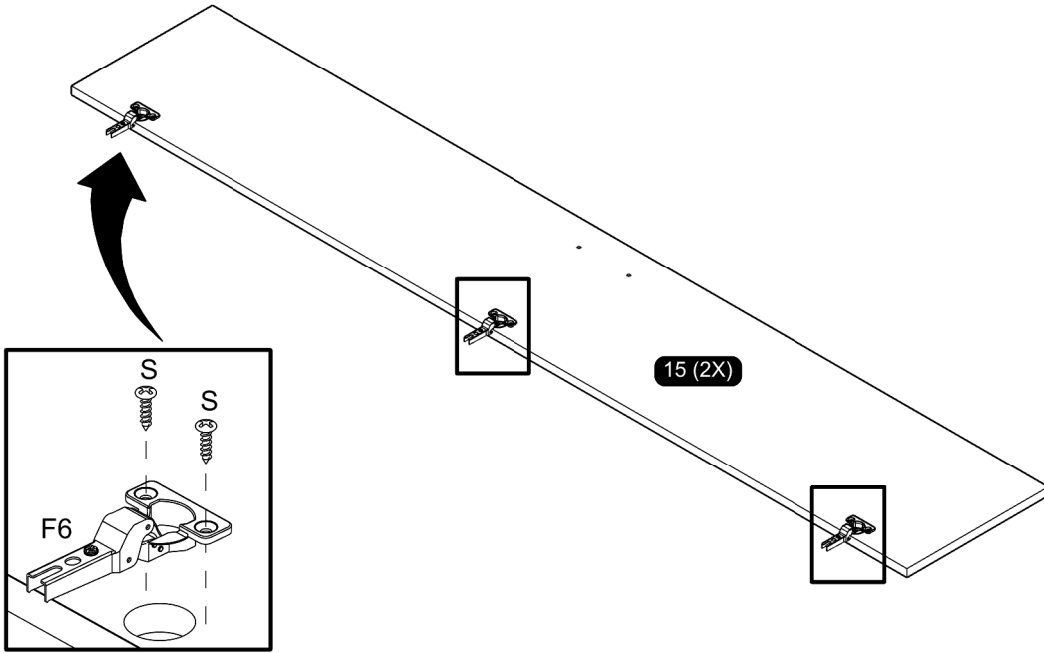

05

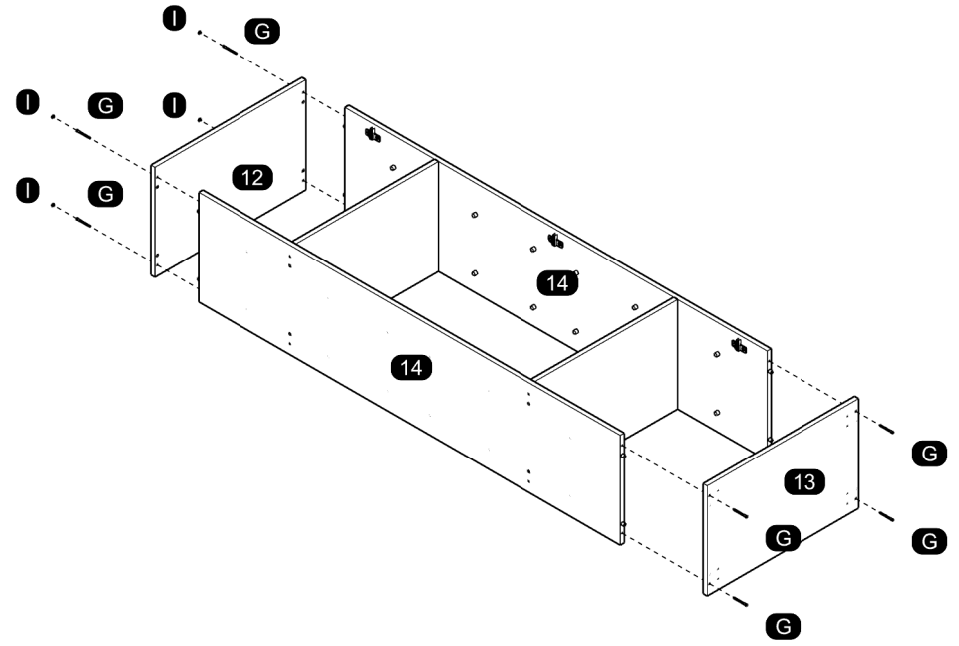

04

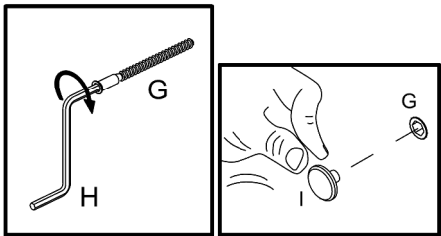
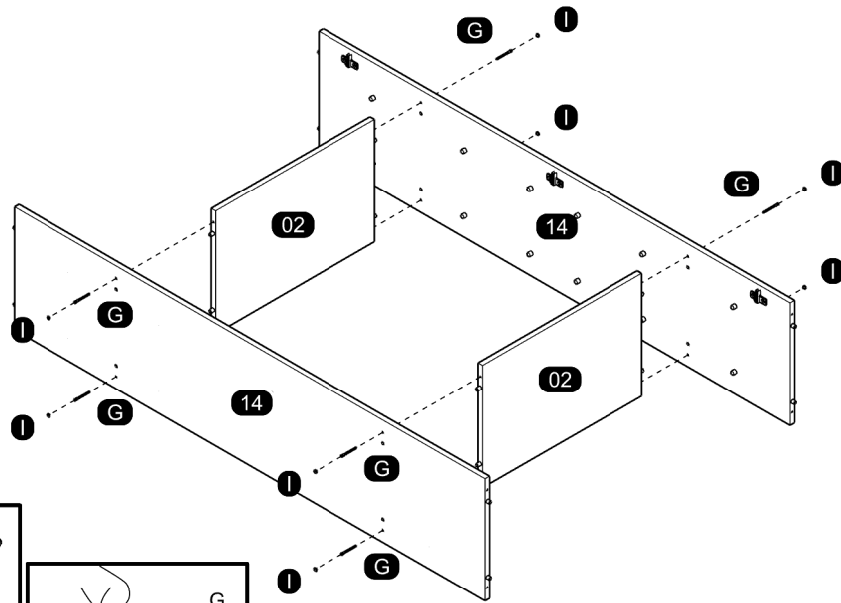

06

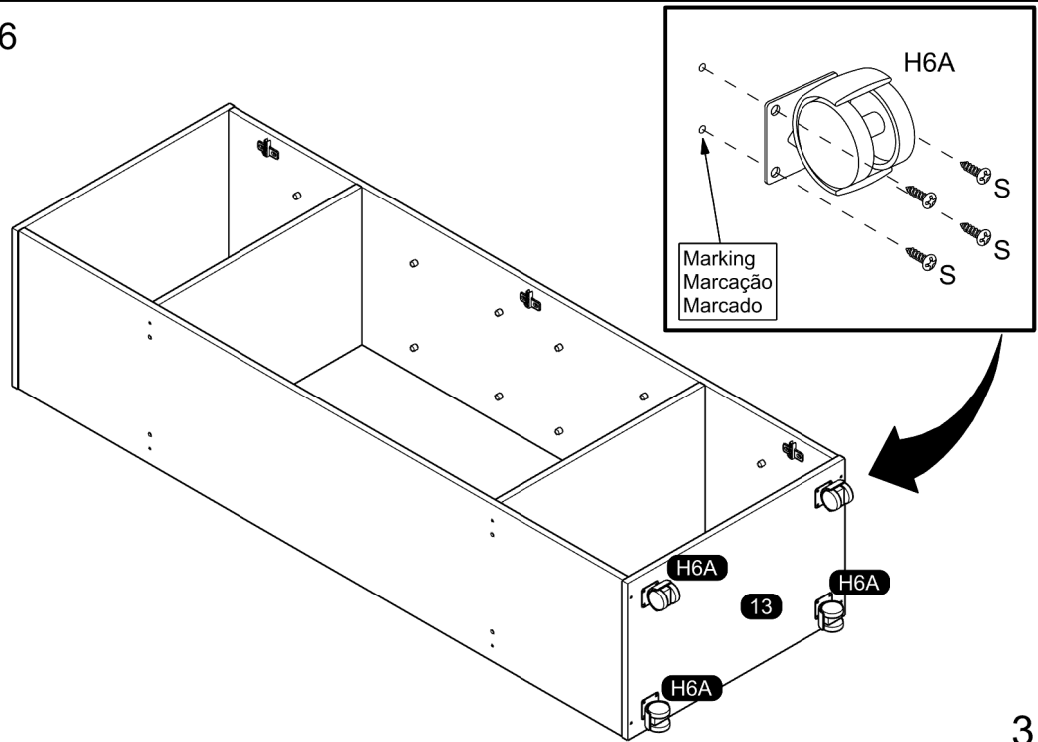

07

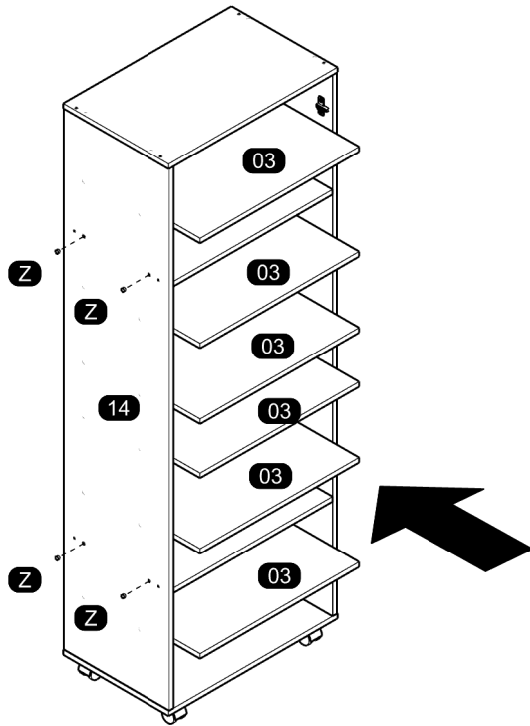
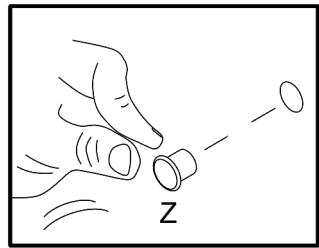

09

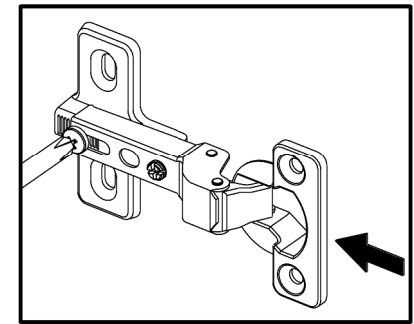
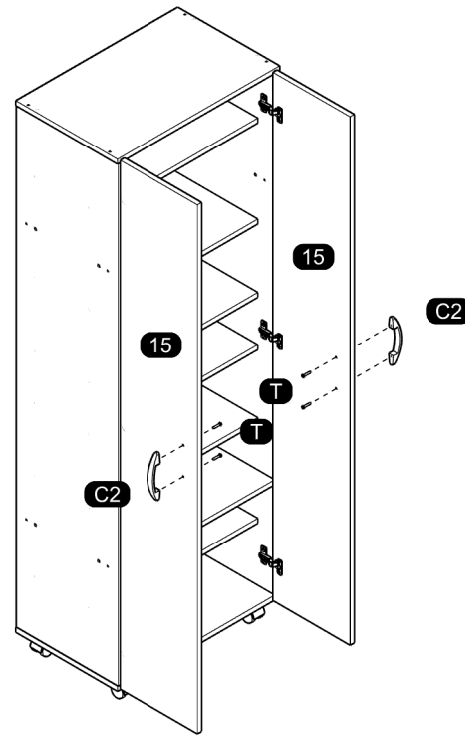

08

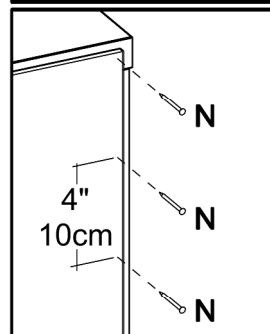
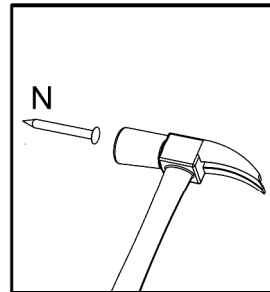
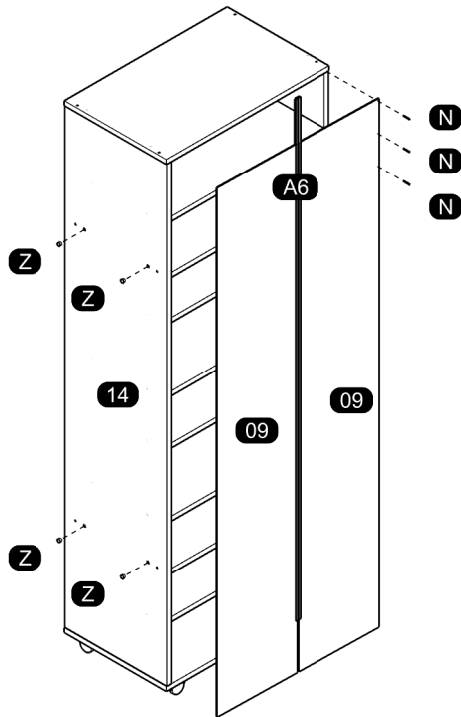

10

